

# DOMUS NOVA

## Ladbroke Gardens

Notting Hill W11

APPROXIMATE GROSS INTERNAL AREA

434 sq ft / 40.32 sq m

020 7727 1717

domusnova.com

LONDON | IBIZA

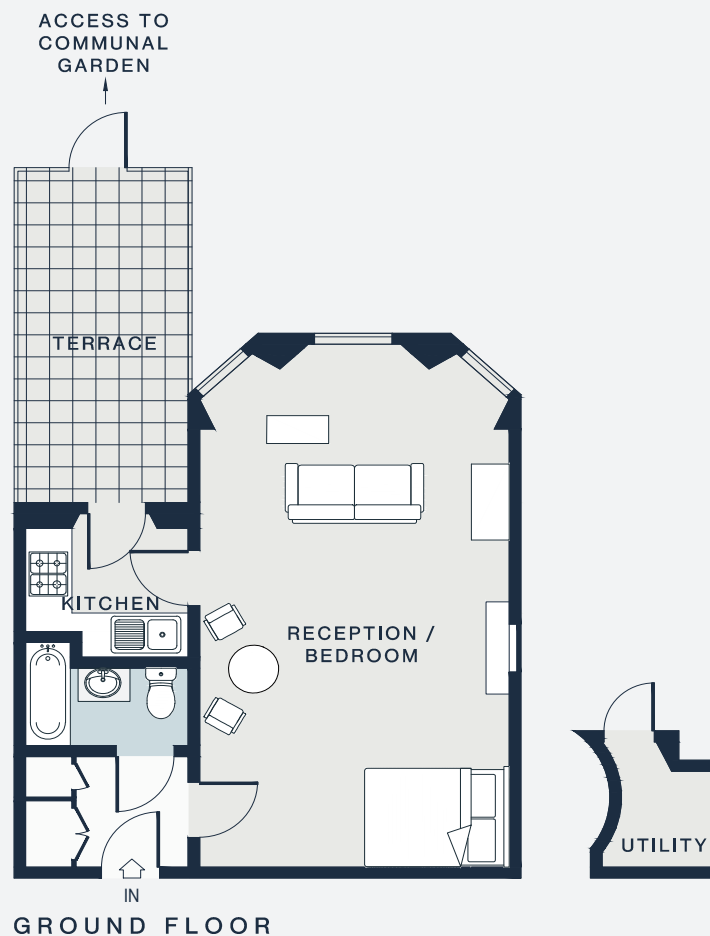

RECEPTION / BEDROOM

23'3 x 13'2 (7.1m x 4.0m)

KITCHEN

6'10 x 6'5 (2.1m x 2.0m)

UTILITY

5'7 x 4'9 (1.7m x 1.4m)

Approx. Gross Internal Area = 434 sq ft / 40.32 sq m (Including Utility)

Floor plans are for illustrative purposes only and not to scale. Compliant with RICS code of measuring practice. Furniture layouts are indicative only. This property may be furnished, part-furnished or unfurnished. Please refer to your agent for details.