

DOMUS NOVA

Durham Terrace

Bayswater W2

APPROXIMATE GROSS INTERNAL AREA

455 sq ft / 42.27 sq m

020 7727 1717

domusnova.com

LONDON | IBIZA

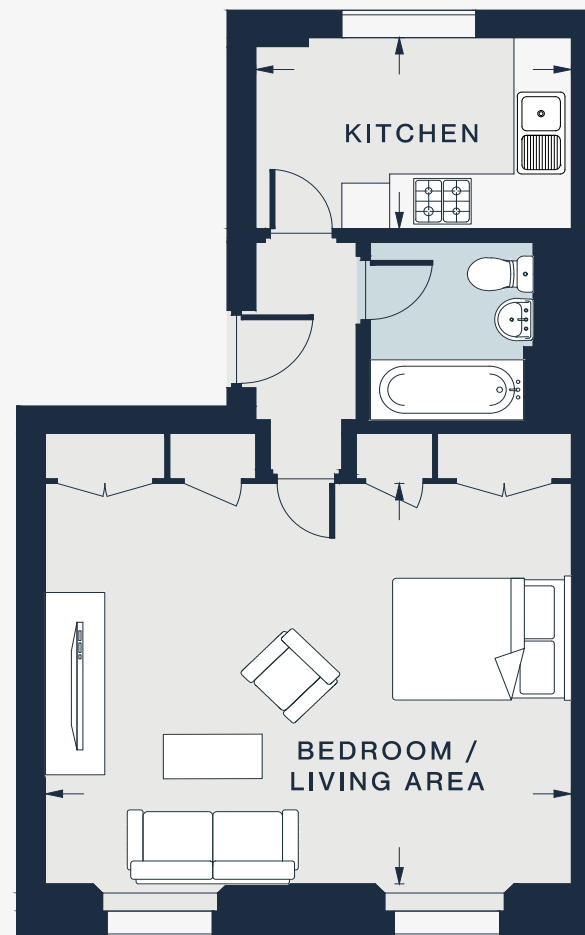

SECOND FLOOR

KITCHEN

10'9 x 6'11 (3.3m x 2.1m)

STUDIO

18'1 x 14'5 (5.5m x 4.4m)

Approx. Gross Internal Area = 455 sq ft / 42.27 sq m

Floor plans are for illustrative purposes only and not to scale. Compliant with RICS code of measuring practice. Furniture layouts are indicative only. This property may be furnished, part-furnished or unfurnished. Please refer to your agent for details.