

# DOMUS NOVA



Bassett Road, W10  
£650,000







A stained glass surrounded front door provides a fittingly handsome shared entrance to this Bassett Road apartment. Up on the first floor, interiors by Marianne Roe of Studio Smiths unfold, creating sophisticated, calming spaces.

The heart of the home, the open-plan kitchen and reception room, is awash with neutral tones. Organic textures and accents of pink and gold add a touch of luxury, and pair perfectly with the generous period proportions. A ceiling rose draws the eye upwards in the reception room, while elegant cornicing, high ceilings and cast-iron radiators continue to ground the home in its heritage. A large south-facing sash window casts light into the living area, highlighting its newly refurbished qualities.

A Shaker-style kitchen sits subtly separated by a polished quartz-topped breakfast bar. A brushed brass tap elevates an undermounted sink, while handles in the same brass adorn the cabinetry, complementing the sapphire gold veins that run through the countertop.









“ A ceiling rose draws the eye upwards in the reception room, while elegant cornicing, high ceilings and cast-iron radiators continue to ground the home in its heritage.









At the back of the home, the bedroom unfolds in a sea of considered details. Sisal carpet is comforting underfoot, emphasising the space's intention for relaxation. A wall-to-wall window illuminates the bespoke wardrobes and dressing table. Across the hallway, the bathroom has been recently replumbed and adorned in porcelain tiles. A custom-built mirror cabinet sits above the vanity while Lusso Stone black matte hardware adds a tonal contrast to the neutral hues that dominate.



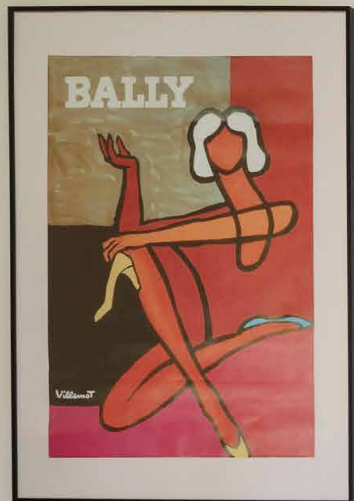





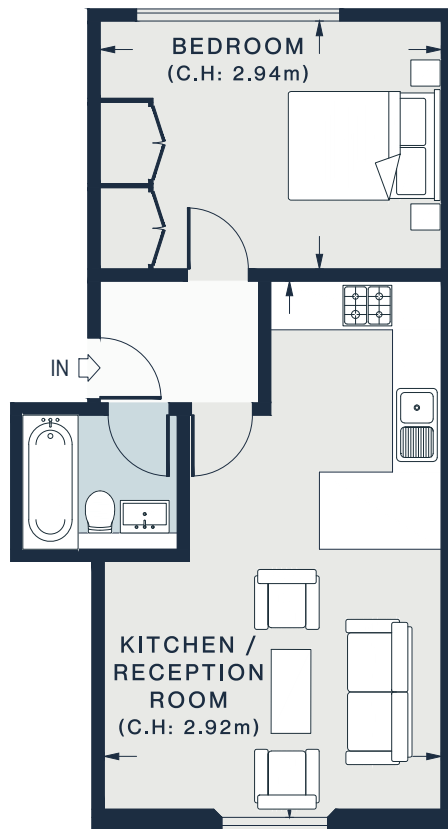

FIRST FLOOR

KITCHEN /  
RECEPTION ROOM  
21'11 x 13'6 (6.7m x 4.1m)

BEDROOM  
13'8 x 9'10 (4.2m x 3.0m)

Approx. Gross Internal Area = 456 sq ft / 42 sq m

Floor plans are for illustrative purposes only and not to scale. Compliant with RICS code of measuring practice.  
Prepared for Domus Nova. Copyright © All Rights Reserved.

## Property Details

Interior design by Marianne Roe at Studio Smiths  
Open-plan kitchen and reception room  
Principal bedroom  
Contemporary bathroom  
Smart Hive thermostat  
Nighttime security on Bassett Road  
Royal Borough of Kensington & Chelsea

Approx. 456 sq ft / 42 sq m

EPC=D

Tenure: Leasehold

Lease Length: Circa. 98 years

Council Tax Band: D



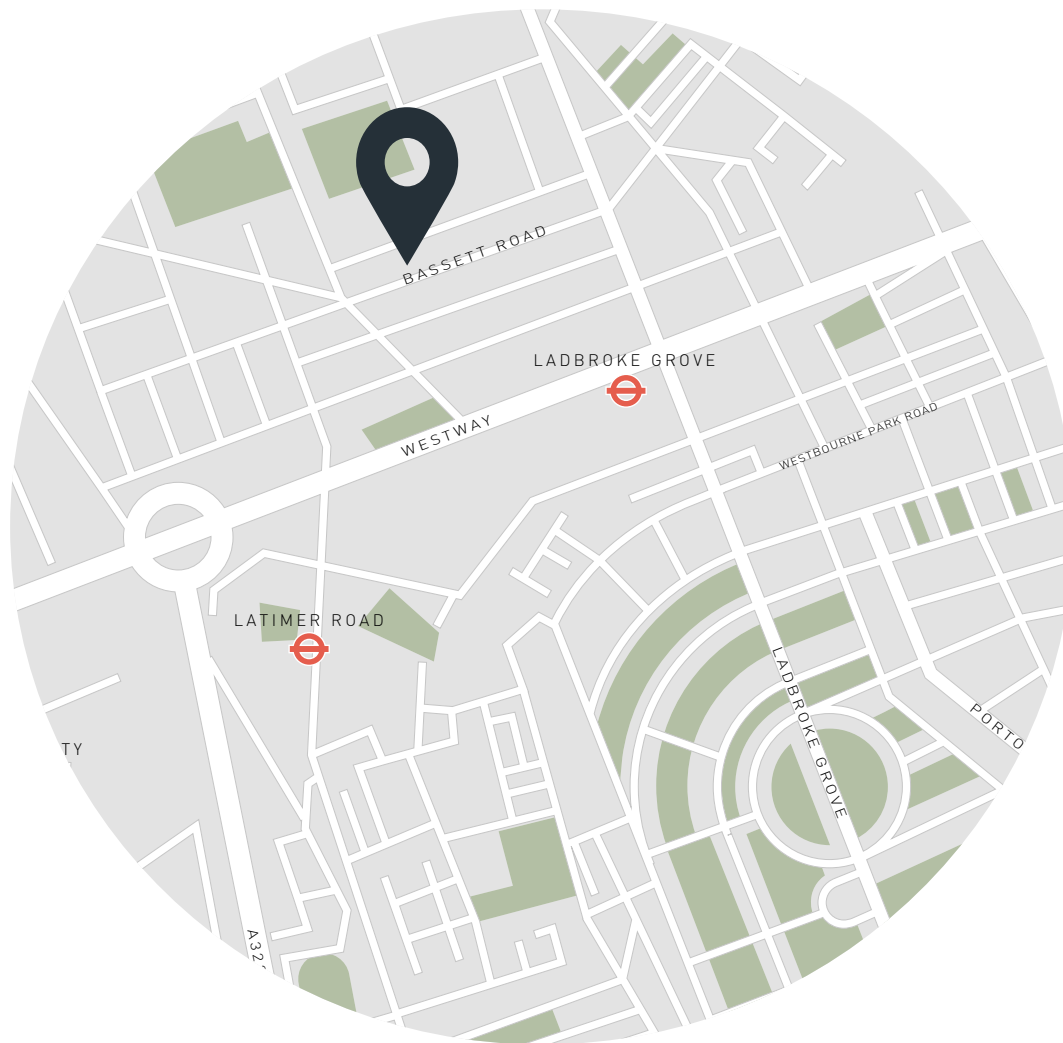

## Location

One of North Kensington's most desirable locations, Bassett Road puts you moments from prime Notting Hill. Visit the famous market in the mornings, then spend time discovering the area's favourite neighbourhood haunts best-kept secrets. Layla's Bakery, Canteen and Golborne Deli & Wine Store are only a six-minute walk away and Buns From Home is just over ten. Settle in for a night of great food and even better tunes at Caia, or head to Gold for a late-evening tipple. Westbourne Grove is lined with independent boutiques or Ladbroke Grove station can take you wherever you need to go.

Ladbroke Grove – 6 mins (Circle, Hammersmith & City)

Specialising in London  
and Ibiza's design-led homes

Let's talk  
020 7221 7817  
sales@domusnova.com  
domusnova.com

The particulars above are a guide, not an offer or contract. Descriptions, photographs and plans are not statements or representations of fact. Measurements are approximate and not to scale. Prospective purchasers must verify the accuracy of the information within the particulars. Domus Nova does not give any representations or warranties; nor represent the Seller legally. Domus Nova has no liability, for any costs, losses or expenses incurred by the Seller or a prospective buyer relating to the sales and buying transaction.

Our Sales Disclaimer, trading names and privacy policy on how your data is processed and used is found in full on our website in our [Privacy Statement](#).

© Domus Nova 2025. All rights reserved.